

Anschlussnippel mit Außengewinde, US-Standard, mit/ohne Ventil

Externally Threaded Nipple, US-Standard, with/without Valve

S3450/ . . .

Mat.: 2.0401 (Messing)

Mat.: 2.0401 (Brass)

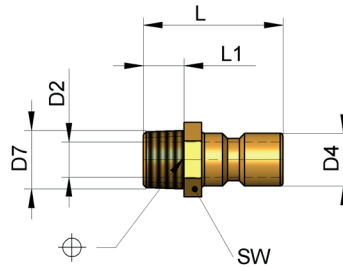

L	L1	SW	D2	D4	D7	Best. Nr. / Order No. ↺↻	Best. Nr. / Order No. ↔
23	8	13	6	9	M10x1		S3450/ 9xM10
24	9				R1/8		S3450/ 9x 1/8
29	12	16	9	13	R1/4		S3450/ 9x 1/4
	14				R1/4	S3450/ 9x 1/4 V	S3450/ 9xM12
30	12	19	9	13	R3/8		S3450/ 9x 3/8
34	12	16			R1/4	S3450/ 13x 1/4 V	S3450/ 13x 1/4
		19	R3/8	S3450/ 13x 3/8 V	S3450/ 13x 3/8		
39	17	24	16	19	R1/2		S3450/ 13x 1/2
44	17	22			R1/2		S3450/ 19x 1/2
45	19	29			R3/4		S3450/ 19x 3/4