

Gewinde-Verschlussstopfen, konisch

Hexagon Socket Pipe Plug, with Tapered Thread

S3530/ . . .

Mat.: 2.0401 (Messing)

Mat.: 2.0401 (Brass)

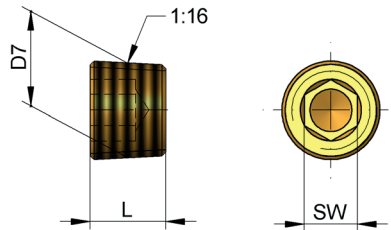

L	SW	D7	Best. Nr. / Order No.
8	4	M8x0,75	S3530/ M8
8	5	M10x1	S3530/ M10
8	5	1/8" BSPT	S3530/ 1/8
8	6	M12x1,5	S3530/ M12
10	7	1/4" BSPT	S3530/ 1/4
10	7	M14x1,5	S3530/ M14
10	8	3/8" BSPT	S3530/ 3/8
10	10	1/2" BSPT	S3530/ 1/2